



## **1/4' x 31' Gr30 Safety Chain, 5k, 7/16 hook w/latch**

1/4' x 31' Gr30 Safety Chain, 5k, 7/16 hook w/latch

[Read More](#)

**SKU:** 8850029

**Categories:** [Safety Chains](#)

### **Product Description**

1/4' x 31' Gr30 Safety Chain, 5k, 7/16 hook w/latch

---



## 1/4x30 Safety Chain, 12.6K, GR70, 1/4 Forged Hook w/Latch

1/4x30 Safety Chain, 12.6K, GR70, 1/4 Forged Hook w/Latch

[Read More](#)

SKU: 8850024

Categories: [Safety Chains](#)

### Product Description

1/4x30 Safety Chain, 12.6K, GR70, 1/4 Forged Hook w/Latch

---

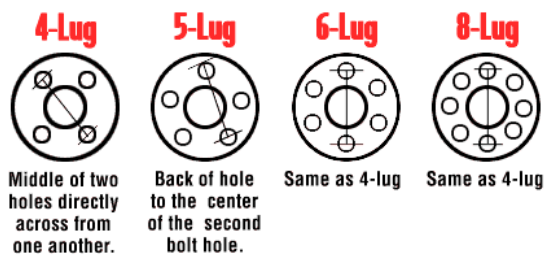

## 14" Bolt Pattern Measure Method

HOW TO MEASURE YOUR BOLT PATTERN; CLICK ON THE IMAGE FOR A LARGER PIC!!!!

[Read More](#)

SKU: 14" Bolt Pattern Measure Method - SKU

Categories: [14"](#), [Bolt Pattern Measure Method](#)

### Product Description

---

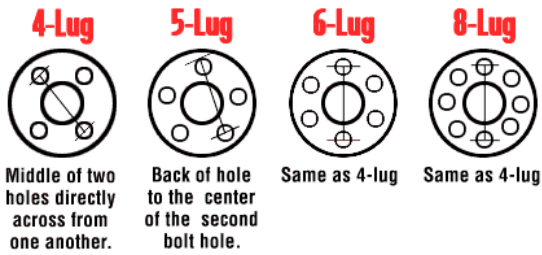

## 16" BOLT PATTERN

HOW TO MEASURE BOLT PATTERNS; CLICK ON THE IMAGE FOR A LARGER VIEW!!!!!!!!!!

[Read More](#)

**SKU:** 16" BOLT PATTERN - SKU

**Categories:** [16"](#), [Bolt Pattern Measure Method](#)

## Product Description

---



## 2 Pack Harley Davidson Decals

HD-2 : 2 Pack Harley Davidson Decals FREE SHIPPING TO THE LOWER 48 US STATES ONLY. CONTACT US FOR INTERNATIONAL SHIPPING. 912 367 3007 EXT 310

[Read More](#)

**SKU:** HD-2

**Categories:** [Decals](#)

## Product Description

***2 Pack : Huge Harley Decal and will make your trailer look AWESOME!!***

---



## **2 x 27 Wide Handle Ratchet Strap with Flat Hook**

2 x 27 Wide Handle Ratchet Strap with Flat Hook

[Read More](#)

**SKU:** 2x27FH

**Categories:** [Tie Down Straps](#)

### **Product Description**

Style: Flat Hook

Handle: Wide

2" x 27'

Break Strength: 10,000

WLL: 3,333 lbs

---



## **2 x 27 Wide Handle Ratchet Strap with Wire Hook**

2 x 27 Wide Handle Ratchet Strap with Wire Hook

[Read More](#)

**SKU:** 2x27WH

**Categories:** [Tie Down Straps](#)

### **Product Description**

Style: Wire Hook

Handle: Wide

2" x 27'

Break Strength: 10,000

WLL: 3,333 lbs

---



## 2" x 8' Axle Ratchet Strap BLACK

S26108-SH-BLK : 2" x 8' Axle Ratchet Strap BLACK

[Read More](#)

**SKU:** S26108-SH-BLK

**Categories:** [Tie Down Straps](#)

### Product Description

Brand: PCC

2" x 8' Axle Ratchet Strap w/ Cordura protective sleeve

Color: Black

Features (2) 2" Flat Snap Hooks on each end

2" wide Ratchet Buckle

Working Load Limit: 2000 LBS

Assembled in USA by PCC



## 3 Pack Harley Davidson Decals

HD-3 : 3 Pack Harley Davidson Decals FREE SHIPPING TO THE LOWER 48 US STATES ONLY. CONTACT US FOR INTERNATIONAL SHIPPING. 912 367 3007 EXT 310

[Read More](#)

**SKU:** HD-3

**Categories:** [Decals](#)

## Product Description

***3 Pack : Huge Harley Decal and will make your trailer look AWESOME!!***



### **3/8' x 38' Safety Chain, 16.2K, Gr43 Hook w/latch**

3/8' x 38' Safety Chain, 16.2K, Gr43 Hook w/latch

[Read More](#)

**SKU:** 8850032

**Categories:** [Safety Chains](#)

## Product Description

3/8' x 38' Safety Chain, 16.2K, Gr43 Hook w/latch

---



## 4 x 27 Winch Strap with Flat Hook

4 x 27 Winch Strap with Flat Hook

[Read More](#)

**SKU:** 43795-10-27

**Categories:** [Tie Down Straps](#)

### Product Description

Brand: ANCRA

4" x 27'

Break Strength: 15,000

WLL: 5,000 lbs

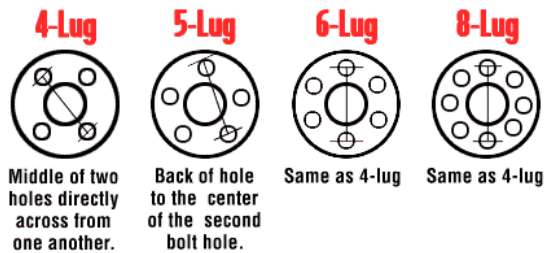

### A Blank Product

HOW TO MEASURE YOUR BOLT PATTERN; CLICK ON IMAGE FOR LARGER PICS!!!

[Read More](#)

**SKU:** 15" BOLT PATTERN

**Categories:** [15"](#), [Bolt Pattern Measure Method](#)

### Product Description



## Ankra Cargo 50140-10 Load Binder

Ankra Cargo 50140-10 Load Binder

[Read More](#)

SKU: 005-059-00(4)-1-1-1-1

Categories: [Axles](#), [Tie Down Straps](#)

### Product Description

- Ankra Cargo 50140-10 Load Binder
- 5,400 WLL
- Self contained chain binder to secure loads.
- Works in combination with 5/16-in grade 70 or 3/8-in grade 43 chain assemblies.
- Makes loading and unload faster
- Extra long molded grip ratchet handle
- Steel construction with electro zinc plating. Free wheel function for quick take up. Swivel grab hooks.



## Ankra Cargo 50140-11 Load Binder

Ankra Cargo 50140-11 Load Binder

- High-strength steel with electro zinc plating

- Free wheel function for quick take up to 12"
- Working Load Limit of 6,600 lbs/3,000 kgs
- Accepts chain from 5/16-in. G70 up to 3/8-in. G70
- Durable and long lasting

[Read More](#)

**SKU:** 005-059-00(4)-1-1-1-1-1

**Categories:** [Axles](#), [Tie Down Straps](#)

## Product Description

- Ancra Cargo 50140-11 Load Binder
- 6,600 WLL
- High-strength steel with electro zinc plating
- Free wheel function for quick take up to 12"
- Working Load Limit of 6,600 lbs/3,000 kgs
- Accepts chain from 5/16-in. G70 up to 3/8-in. G70
- Durable and long lasting

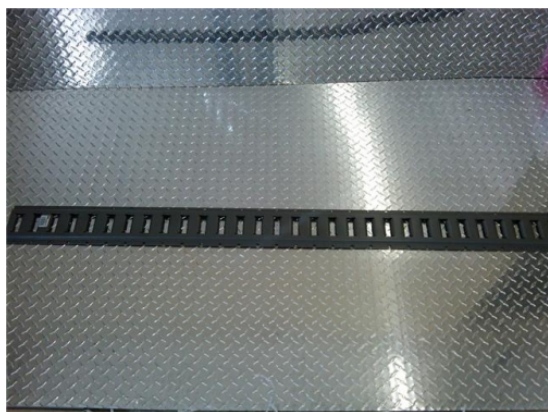

## Black 5' Horizontal Etrack

5" Black Horizontal Etrack!

[Read More](#)

**SKU:** 5GETrackH

**Categories:** [E Track](#)

## Product Description

Etrack Color: Black

Material: High-strength steel; 12 gauge

Minimum Yield: 50,000 psi

Finish: Gray, Powder Coat

Dimensions: 5"Wide x 1/2"Height

Mounting Holes are Spaced 2" apart.

Weight: 8.0 lbs./3.6 kgs

Length:5.0 ft./1.5 m.

---



## BoatBuckle 1" x 6' Auto Ratcheting Strap BLACK

F106877 : BoatBuckle 1" x 6' Auto Ratcheting Strap BLACK

[Read More](#)

SKU: F106877

Categories: [Tie Down Straps](#)

### Product Description

Brand: Boat Buckle

1" x 7' Auto Ratcheting Strap

Color: Black

1" wide Ratchet Buckle

Break Strength: 1400 LBS

Working Load Limit: 466 LBS



## Buyer Products 6x14 Dump Trailer Tarp Kit Complete w/ Mesh Tarp

Dump Trailer Tarp Kit to fit 6' Wide and up to 14' in Length Dump

TrailersIncludes Mesh Tarp and Hardware

[Read More](#)

SKU: DTR6014

Categories: [Dump Tarp Kits](#)

## Product Description

**ALUMINUM TARP SYSTEM WITH MESH TARP 6 X 14 FOOT**

**BUYERS PRODUCTS DTR SERIES DUMP TARP KITS ARE BUILT FOR SIMPLE DUMP BODY AND DUMP TRAILER TARP APPLICATIONS.**

**BUILT FOR SIMPLE DUMP BODY AND DUMP TRAILER TARP APPLICATIONS**

**EXTRA DURABLE TARPS FEATURE BRASS GROMMETS AND HEAVY DUTY DOUBLE-STITCHED AND REINFORCED HEMS.**

**SOLID VINYL TARP ARE RATED TO 400° F FOR COVERING ASPHALT.**

**EACH TARP HAS A STANDARD SEWN-IN REAR POCKET TO FIT AN OPTIONAL ANTI-SAIL RETENTION BOW (SOLD SEPARATELY).**

**ALL MOUNTING HARDWARE INCLUDED.**

### **SPECIFICATIONS**

**ANTI-SAIL RETENTION BOW INCLUDED (Y/N) NO**

**CRANK HANDLE LENGTH 7"**

**LENGTH OF RUBBER STRAPS INCLUDED 15"**

**NUMBER OF RUBBER TIE DOWN STRAPS INCLUDED 2**

**PULL ROPE INCLUDED (Y/N) YES**

**PULL ROPE LENGTH 20'**

**SYSTEM STYLE MANUAL DUMP TARP INCLUDED (Y/N) YES**

**TARP LENGTH 12.0'**

**TARP MATERIAL PVCCOATED VINYL MESH**

**TARP WIDTH 6.5'**

**UV INHIBITOR (Y/N) YES**

**WIND DEFLECTOR INCLUDED (Y/N) NO**

---



## **Buyer Products 7x15 Dump Trailer Tarp Kit Complete w/ Mesh Tarp**

Dump Trailer Tarp Kit to fit 7' Wide and up to 15' in Length Dump TrailersIncludes Mesh Tarp and Hardware

[Read More](#)

**SKU:** DTR7015

**Categories:** [Dump Tarp Kits](#)

### **Product Description**

**ALUMINUM TARP SYSTEM WITH MESH TARP 7 X 15 FOOT**

**BUYERS PRODUCTS DTR SERIES DUMP TARP KITS ARE BUILT FOR SIMPLE DUMP BODY AND DUMP TRAILER TARP APPLICATIONS.**

**BUILT FOR SIMPLE DUMP BODY AND DUMP TRAILER TARP APPLICATIONS**

**EXTRA DURABLE TARPS FEATURE BRASS GROMMETS AND HEAVY DUTY DOUBLE-STITCHED AND REINFORCED HEMS.**

**SOLID VINYL TARP ARE RATED TO 400° F FOR COVERING ASPHALT.**

**EACH TARP HAS A STANDARD SEWN-IN REAR POCKET TO FIT AN OPTIONAL ANTI-SAIL RETENTION BOW (SOLD SEPARATELY).**

**ALL MOUNTING HARDWARE INCLUDED.**

#### **SPECIFICATIONS**

**ANTI-SAIL RETENTION BOW INCLUDED (Y/N) NO**

**CRANK HANDLE LENGTH 7"**

**LENGTH OF RUBBER STRAPS INCLUDED 15"**

**NUMBER OF RUBBER TIE DOWN STRAPS INCLUDED 2**

**PULL ROPE INCLUDED (Y/N) YES**

**PULL ROPE LENGTH 20'**

**SYSTEM STYLE MANUAL DUMP TARP INCLUDED (Y/N) YES**

**TARP LENGTH 12.0'**

**TARP MATERIAL PVCCOATED VINYL MESH**

**TARP WIDTH 7.5'**

**UV INHIBITOR (Y/N) YES**

**WIND DEFLECTOR INCLUDED (Y/N) NO**



## **Buyer Products 7x18 Dump Trailer Tarp Kit Complete w/ Mesh Tarp**

Dump Trailer Tarp Kit to fit 7' Wide and up to 15' in Length Dump TrailersIncludes Mesh Tarp and Hardware

[Read More](#)

**SKU:** DTR7018

**Categories:** [Dump Tarp Kits](#)

### **Product Description**

**ALUMINUM TARP SYSTEM WITH MESH TARP 7 X 18 FOOT**

**BUYERS PRODUCTS DTR SERIES DUMP TARP KITS ARE BUILT FOR SIMPLE DUMP BODY AND DUMP TRAILER TARP APPLICATIONS.**

**BUILT FOR SIMPLE DUMP BODY AND DUMP TRAILER TARP APPLICATIONS**

**EXTRA DURABLE TARPS FEATURE BRASS GROMMETS AND HEAVY DUTY DOUBLE-STITCHED AND REINFORCED HEMS.**

**SOLID VINYL TARP ARE RATED TO 400° F FOR COVERING ASPHALT.**

**EACH TARP HAS A STANDARD SEWN-IN REAR POCKET TO FIT AN OPTIONAL ANTI-SAIL RETENTION BOW (SOLD SEPARATELY).**

**ALL MOUNTING HARDWARE INCLUDED.**

## SPECIFICATIONS

ANTI-SAIL RETENTION BOW INCLUDED (Y/N) NO

CRANK HANDLE LENGTH 7"

LENGTH OF RUBBER STRAPS INCLUDED 15"

NUMBER OF RUBBER TIE DOWN STRAPS INCLUDED 2

PULL ROPE INCLUDED (Y/N) YES

PULL ROPE LENGTH 20'

SYSTEM STYLE MANUAL DUMP TARP INCLUDED (Y/N) YES

TARP LENGTH 12.0'

TARP MATERIAL PVCCOATED VINYL MESH

TARP WIDTH 7.5'

UV INHIBITOR (Y/N) YES

WIND DEFLECTOR INCLUDED (Y/N) NO



## Buyers Detented Tarp Crank Bracket For DTR Series Dump Tarp Kits

Buyers Detented Tarp Crank Bracket For DTR Series Dump Tarp  
Kits

[Read More](#)

SKU: 3009501

Categories: [Dump Tarp Kits](#)

## Product Description

Buyers Detented Tarp Crank Bracket For DTR Series Dump Tarp Kits

---

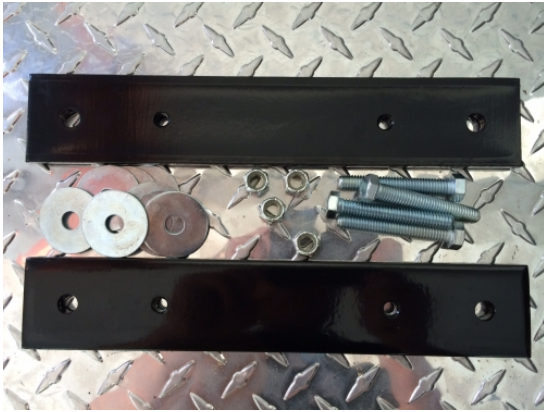

## CONDOR SC3000 Removable Mount Kit for SC2000 SC 2000 Chocks

CONDOR SC3000 Removable Mount Kit for SC2000 SC 2000!!!!!!

[Read More](#)

SKU: SC-3000

Categories: [CONDOR Motorcycle Chocks](#)

### Product Description

***This is the CONDOR Removable Motorcycle Wheel Chock Adapter Kit SC-3000, which converts your stationary SC2000 Wheel Chock into a Removable Wheel chock.***

Made in the [USA](#) by Technical Components Development & Designs, INC.

Our **CONDOR**® adaptor works on all forms of transport platforms such as trailers and flatbeds.

With the help of the **CONDOR**® Adaptor Kit, the **CONDOR**® Pit-Stop/Trailer-Stop is easily attached and detached from any trailer, flatbed or pickup truck. Attaching and detaching takes only a few seconds, it's as simple as removing the locking wing bolt and sliding the Pit-Stop/Trailer-Stop out of the TK3000 bracket keyway. With the Trailer-Stop and Adaptor Kit, Tying down a motorcycle becomes a simple and an easy task for one person. In most cases, the motorcycle needs only to be tied down with two straps, one on either side with attachments towards the middle or the rear of the motorcycle. Both straps would only need to push the motorcycle down and forward towards the locking direction of the TK3000 keyway bracket. You will be amazed at how secure and safe your ride will be once tied down in the **CONDOR**® Trailer-Stop. The **Condor**® Pit-Stop/Trailer-Stop accommodates bikes weighing up to 2400 lbs, disconnects in seconds and is low profile.

**PACKAGE IS BACKED BY A 1 YEAR WARRANTY**

**Down 2 Earth Trailers is an authorized CONDOR Dealer**



X



## CONDOR TK3000 Removable Mount Kit for PS1500 PS 1500

CONDOR TK3000 Removable Mount Kit for PS1500 PS 1500!!!!!!

[Read More](#)

SKU: TK-3000

Categories: [CONDOR Motorcycle Chocks](#)

### Product Description

***This is the CONDOR Removable Motorcycle Wheel Chock Adapter Kit TK-3000, which converts your stationary PS1500 PitStop into a Removable PitStop chock.***

Made in the [USA](#) by Technical Components Development & Designs, INC.

Our **CONDOR®** adaptor works on all forms of transport platforms such as trailers and flatbeds.

With the help of the **CONDOR®** Adaptor Kit, the **CONDOR®** Pit-Stop/Trailer-Stop is easily attached and detached from any trailer, flatbed or pickup truck. Attaching and detaching takes only a few seconds, it's as simple as removing the locking wing bolt and sliding the Pit-Stop/Trailer-Stop out of the TK3000 bracket keyway. With the Trailer-Stop and Adaptor Kit, Tying down a motorcycle becomes a simple and an easy task for one person. In most cases, the motorcycle needs only to be tied down with two straps, one on either side with attachments towards the middle or the rear of the motorcycle. Both straps would only need to push the motorcycle down and forward towards the locking direction of the TK3000 keyway bracket. You will be amazed at how secure and safe your ride will be once tied down in the **CONDOR®** Trailer-Stop. The **Condor®** Pit-Stop/Trailer-Stop accommodates bikes weighing up to 2400 lbs, disconnects in seconds and is low profile.

**PACKAGE IS BACKED BY A 1 YEAR WARRANTY**

**Down 2 Earth Trailers is an authorized CONDOR Dealer**





## D2E Enclosed Trailer Logo Decal 8" x 26"

D2E Enclosed Trailer Logo Decal 8" x 26"

[Read More](#)

SKU: D2ELogo8x26

Categories: [Decals](#)

### Product Description

D2E Enclosed Trailer Decal / Sticker

Measurement: 8" Height x 26" Length

Color: Black/Orange w/ White Border

Material: Vinyl

!



## D2E OEM Tongue Tool Box Buyers

OEM Tongue Box D2E Trailers: Rear Width: 30.5" Front Width: 14.5" Height: 12.5" Depth: 16.75" Includes: 2 Keys and Locking Stainless Handle

[Read More](#)

SKU: 1701283

Categories: [Tongue Boxes](#)

### Product Description

OEM Tongue Box D2E Trailers

Brand: Buyers

Rear Width: 30.5"

Front Width: 14.5"

Height: 12.5"

Depth: 17.75"

Includes: 2 Keys and Locking Stainless Steel Handle

Metal Gauge: 14 ga

X

---



## D2E Trailer Hat Orange / Orange

D2E HatType: Snap BackColor: Orange / Orange Lettering

[Read More](#)

**SKU:** SBOr/OrD2E

**Categories:** [Hats D2E](#)

### Product Description

D2E Hat Type: Snap Back Color: Orange / Orange Lettering

FREE SHIPPING!!

---

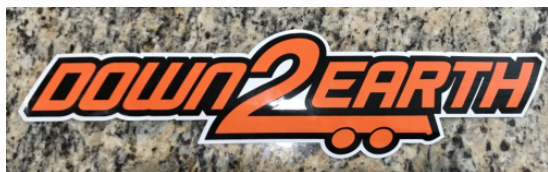

## D2E Trailer Logo Decal 2.75" x 9"

D2E Enclosed Trailer Logo Decal 2.75" x 9"

[Read More](#)

**SKU:** D2ELogo2.75x9

**Categories:** [Decals](#)

### Product Description

D2E Enclosed Trailer Decal / Sticker

Measurement: 2.75" Height x 9" Length

Color: Black/Orange w/ White Border

Material: Vinyl

!

---



## D2E Trailer Logo Decal 5" x 19.5"

D2E Enclosed Trailer Logo Decal 5" x 19.5"

[Read More](#)

**SKU:** D2ELogo5x19.5

**Categories:** [Decals](#)

### Product Description

D2E Enclosed Trailer Decal / Sticker

Measurement: 5" Height x 19.5" Length

Color: Black/Orange w/ White Border

Material: Vinyl

!

---



## D2E Trailer Logo Decal 9" x 32"

D2E Enclosed Trailer Logo Decal 9" x 32"

[Read More](#)

**SKU:** D2ELogo9x32

**Categories:** [Decals](#)

### Product Description

D2E Enclosed Trailer Decal / Sticker

Measurement: 9" Height x 32" Length

Application: Cargo Trailers Color: Black/Orange w/ White Border

Material: Vinyl

!

---

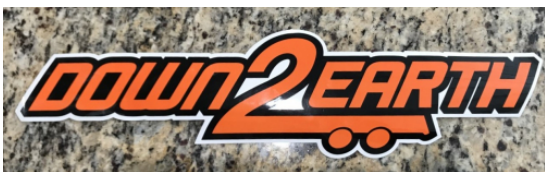

## D2E Trailer Logo Decal 4.25" x 15.5"

D2E Enclosed Trailer Logo Decal 4.25" x 15.5"

[Read More](#)

**SKU:** D2ELogo4.25x15.5

**Categories:** [Decals](#)

## Product Description

D2E Enclosed Trailer Decal / Sticker

Measurement: 4.25" Height x 15.5" Length

Color: Black/Orange w/ White Border

Material: Vinyl

!

---



## Dump Hinge

Dump Hinge for Dump Trailers

[Read More](#)

**SKU:** D2E-Paddle

**Categories:** [Hinges](#)

## Product Description

Dump Hinge for Dump Trailers

Please verify your Dump Trailer uses this type.

---

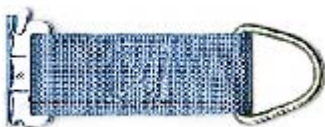

## E Track 2" Rope Tie Off fits E or A Track

660001 : E Track 2" Rope Tie Off fits E or A Track !

[Read More](#)

**SKU:** D2E660001

**Categories:** [E Track](#)

## Product Description

Rope Tie-Offs

2" Rope Tie-Offs with 4900G

Webbing and 1027 D-Ring

660001

**Series E or A**

Weight: 0.4 lbs./0.2 kgs.

Working Load Limit: 1,000 lbs./455 kgs.

FE8306-1 Fitting, Length: 6"

---

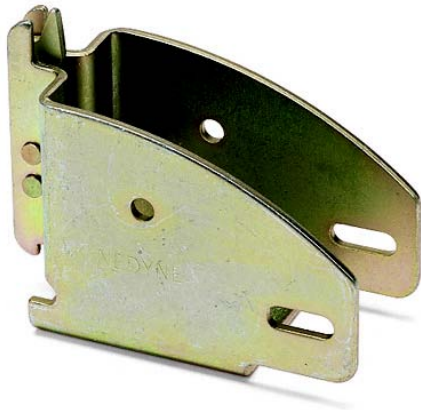

## E Track Beam Support

1845 : E Track Beam Support

[Read More](#)

**SKU:** 1845

**Categories:** [E Track](#)

## Product Description

Features include zinc plating and a positive locking mechanism.

Kinedyne offers both standard and heavy-duty beam sockets designed for use with standard commercial grade 2"x 4" or 2" x 6" lumber.

Load capacity when using

Wood Beam Sockets is based on the strength of the wood beams. Due to variations in lumber strength, load ratings are not provided.

---